



20 Pippins Court, Ashford, TW15 2AF

First Time Purchases don't come better than this.

Pippins Court is a popular development of purpose-built starter homes and offers easy access to most of the area's transport links and local amenities. This property consists of a large lounge - diner, the kitchen which has been separated by a partition wall. The spiral staircase takes you upstairs to a modern bathroom and a large double bedroom with ample room for additional storage. Outside the property has a garden and an allocated parking space.

This is the perfect property for first-time buyers and should be seen to be fully appreciated. Call Aspen Estate Agents to book your viewing.



Floor Plan

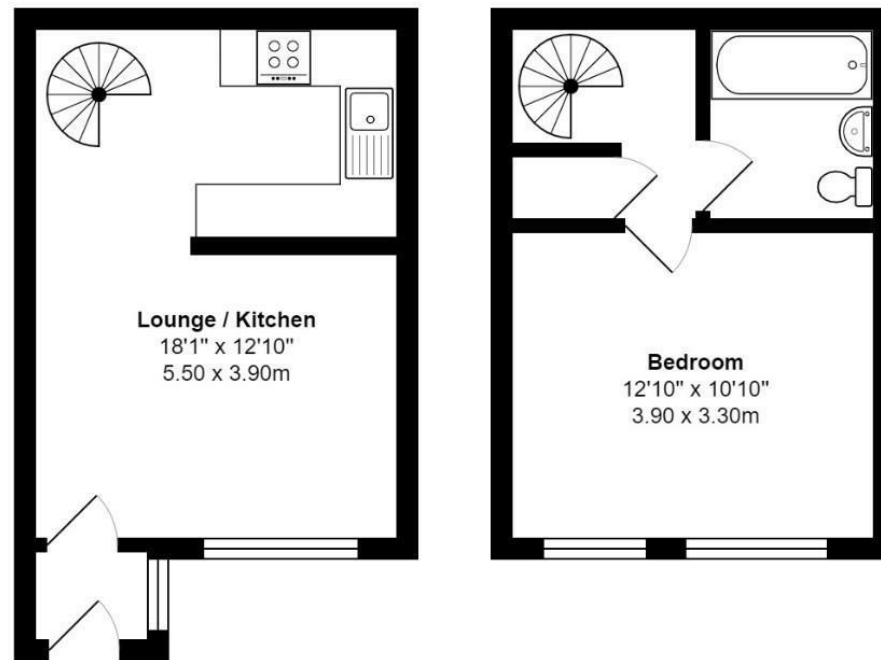

Pippins Court, Ashford

Total Area: 476 ft² ... 44.2 m²

All measurements are approximate and for display purposes only



Features

- Freehold House
- Modern Bathroom
- Allocated Parking Space
- Double Bedroom
- Good Size Lounge
- Ideal First Time Buy / Investment

